

ENERGY EFFICIENCY

Thermal Transmission Coefficient

U_w from 1.0 (W/m²K)

Please consult typology, dimensions and glazing.

ACCOUSTIC INSULATION

Maximum glazing: **40 mm.**

Maximum acoustic insulation: **Rw = 46 dB.**

CATEGORIES ACHIEVED AT TEST CENTRE

Protection against atmospheric agents

Air permeability (UNE-EN 12207:2000):

Class 4

Water tightness (UNE-EN 12208:2000):

Class E1650

Wind resistance (UNE-EN 12210:2000):

Class C5

Reference test window 1.23 x 1.48 m. 1 Sash.

SECTIONS	Frame 70 mm Sash 70 mm	EXTRUSION ALLOY	6063 T-5
PROFILE THICKNESS	Window 1.9 mm	POLYAMIDE STRIP LENGTH	Polyamide 6.6 reinforced with 25% fiberglass: 35 mm
MAXIMUM DIMENSIONS	Width (L) = 1,300 mm Height (H) = 2,400 mm	GASKETS	EPDM triple gasket
MAXIMUM WEIGHT/SASH	160 Kg.	FOAMS	Perimeter polyolefin foam in glazing rebate zone
FINISHES	Colour powder coating (RAL, mottled, rough...) According to Qualicoat >60 microns Wood effect powder coating According to Qualideco standard Anodized According to Ewwa Euras Standard Class 15 Optionally Class 20 and 25 Optionally bicoloured	OPENING POSIBILITIES	INWARDS Side hung, tilt and turn&tilt
	HARDWARE	Optionally concealed hinges Optionally security hardware	

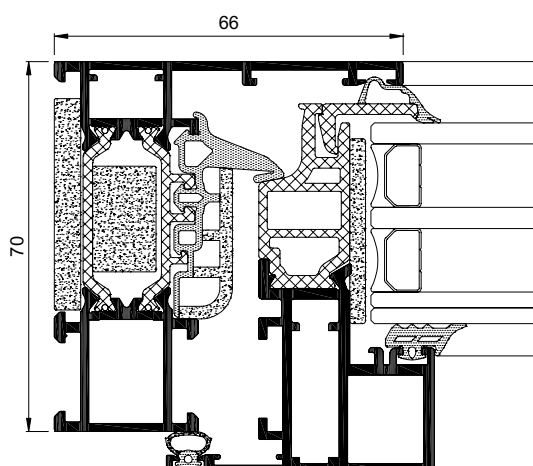



Sample tested by ALUMINIOS CORTIZO S.A.U.



TECHNOLOGICAL CENTRE

Transmittance

$U_w \geq 1,0$ (W/m²K)

Consult typology, dimensions and glass.

Acoustic insulation

Maximum glazing **40 mm**

Maximum acoustic insulation
R_w = 46 dB

Sections

Frame 70 mm
Sash 70 mm

Profile thickness

Window 1,9 mm

Polyamide strip length **35 mm**

Possibility of incorporating hardware with concealed hinges and security hardware - Evo Security.

Categories achieved at test centre

Air permeability
(UNE-EN 12207:2000): Class 4

Water tightness
(UNE-EN 12208:2000): Class E1650

Wind resistance
(UNE-EN 12210:2000): Class C5

Reference test 1,23 x 1,48 m, 2 sashes.

Finishes

Possibility of dual colour
Colour powder coating (RAL, mottled & rough)
Wood effect powder coating
Anti-bacterial powder coating Anodized

Opening possibilities

Open in: Casement 1 & 2 sashes, tilt & turn 1 & 2 sashes, tilt.

Maximum dimensions/sash

Width (L) = 1.300 mm

Height (H) = 2.400 mm

Consult maximum weight and dimensions in accordance to typology

Maximum weight/sash 160 Kg.

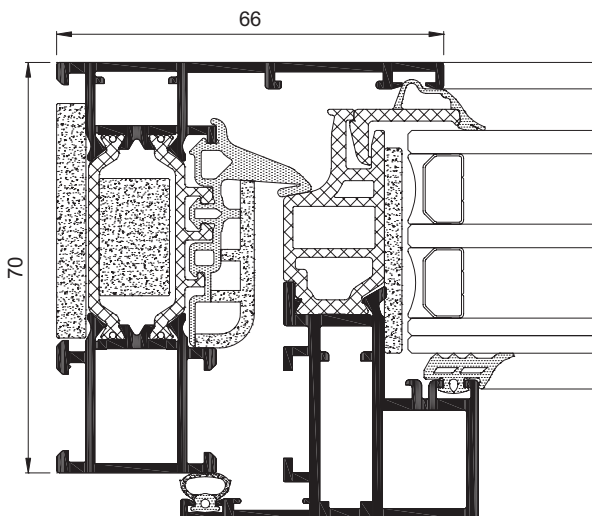

Diego Piñeiro Janeiro
Director de I+D+i / R&D Manager